

**SB**—Slab Bolster

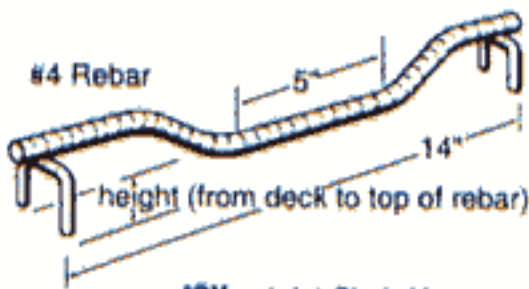

**JCU**—Joist Chair Upper



**BC**—Bar Chair



**BC**—Bar Chair Plastic tipped

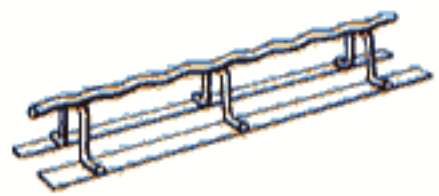

**SBP**—Slab Bolster with Plate



**BCP**—Bar Chair with Plate

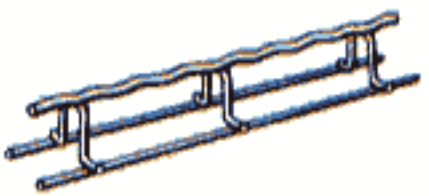

**SBU**—Slab Bolster Upper



**CHC**—Continuous High Chair



Stainless  
dowels on  
chairs  
over 3'



Plastic  
protected  
(dipped)



**HC**—Individual High Chair  
(Plastic tipped legs available)



**BB**—Beam Bolster



**CHCU**—Cont. High Chair Upper



20 ga.

**HCP**—Individual High Chair with Plates  
**FHC**—High Chair for Fill

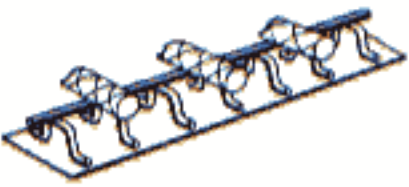

**BBP**—Beam Bolster with Plate

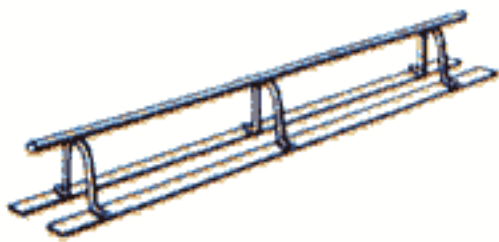

**CHCP**—Continuous High Chair with Plate

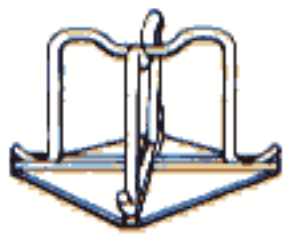

**R-28**—Sand Plate

See  
Page  
10

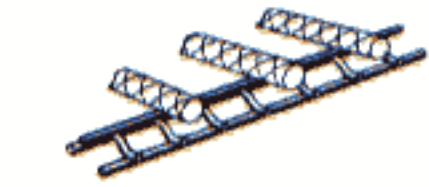

**BBU**—Beam Bolster Upper



**JC**—Joist Chair